



REPLACEMENT MANUAL

HM-0630 REPLACEMENT KIT for Lifebuoy System MkII



REPLACEMENT MANUAL

SPECIFICATION

- One ERU
- One release cord
- One pilot line for loading the lifebuoy
- One replacement manual



1. Secure the lifebuoy during the replacement phase. This is a good opportunity to test the lifebuoy function by activating the Release Switch or pulling the manual safety pin.
2. Disassemble the ERU – use an 8mm fixed spanner. Discard the used ERU in an environmentally approved manner. Make sure that the new ERU is correctly marked before installation. Mount the new ERU – do not tighten too hard!



3. Loosen the locking nut on the release arm and remove the old release cord. Mount the new release cord. The ends of the release cord can be locked during installation by pulling the cord ends into the V-slot. Make sure that projecting section of cord is 20cm length and that the cord is finally well locked by the washer before you tighten the locking nut again.

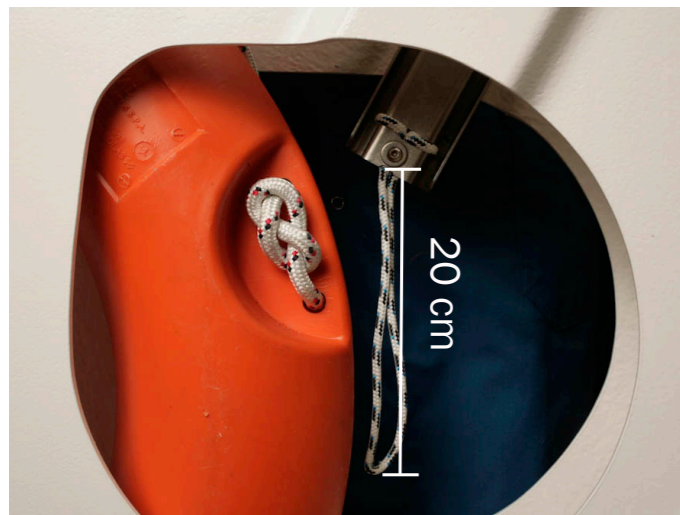

4. Put a lifebuoy 2/3 rds into the GRP holder and then secure it for the installation phase. Use the supplied thin white pilot line to pull the release cord through the ERU unit.



Make sure that the lifebuoy line is not on the outward side of the release cord! This might entangle the lifebuoy in an activation situation.

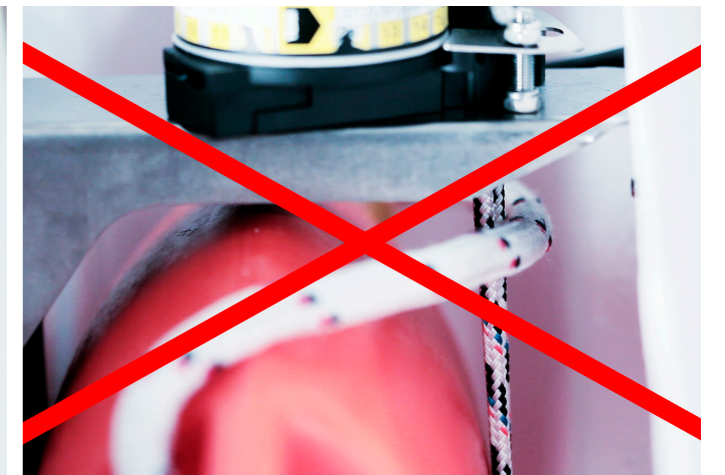
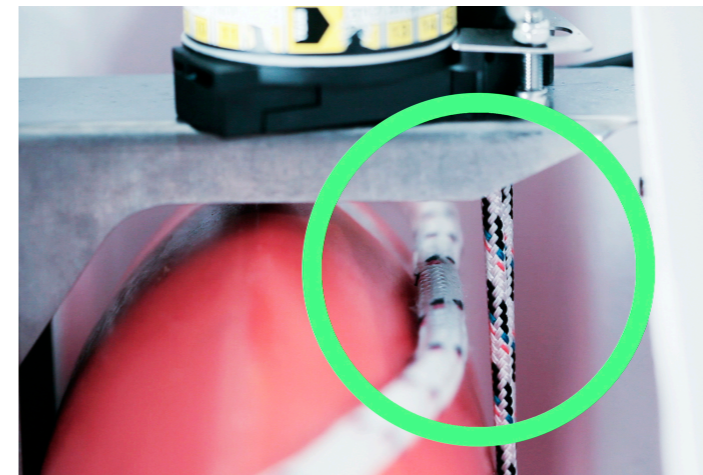

5. Pull up the release cord through the ERU hole with the pilot line. Secure it with the manual safety pin.



6. Connect the ERU cable at the connector box.
7. The safety cover on the Release Switch shall be secured with some kind of easy-to-break seal, in order to avoid unintentional use of the system.
8. The system is now ready for use. The ERU shall be changed after two years of service.

TEST OF THE LIFEBOUY RELEASE SYSTEM

TESTING THE MECHANICAL RELEASE FUNCTION

1. Remove the manual safety pin holding the release cord.
2. The Lifebuoy will be released and launched from the GRP holder.

TESTING THE ELECTRONIC RELEASE FUNCTION BY USING THE EMULATOR HM-0467

1. Open the enclosure of the Emulator and attach two connection wires to the terminals on the Emulator. (Do not use too much torque on the terminal screws)
2. Push the push button on the circuit board to switch on the Emulator. The red and the green LED on the circuit board shall light up simultaneously. The green LED will start flashing green and the device is ready to be used.
3. Open the Connector box (mounted close to the GRP holder) and disconnect the flexible cable of the H20 ERU. Connect the two connection wires from the Emulator to the terminals on the Connector box, where the flexible cable was mounted. (The polarity is not important).

The Emulator can be left without observation mounted to the Connector box, as the Emulator will hold the indication of the LED turning from green to red if activated until the device is reset manually.

4. Push the Release Switch (should be mounted on the bridge or inside the wheelhouse) to activate the output of the Lifebuoy Release unit. The Emulator's LED will change from LED flashing green to LED flashing red if the output has been activated and the system is functional.

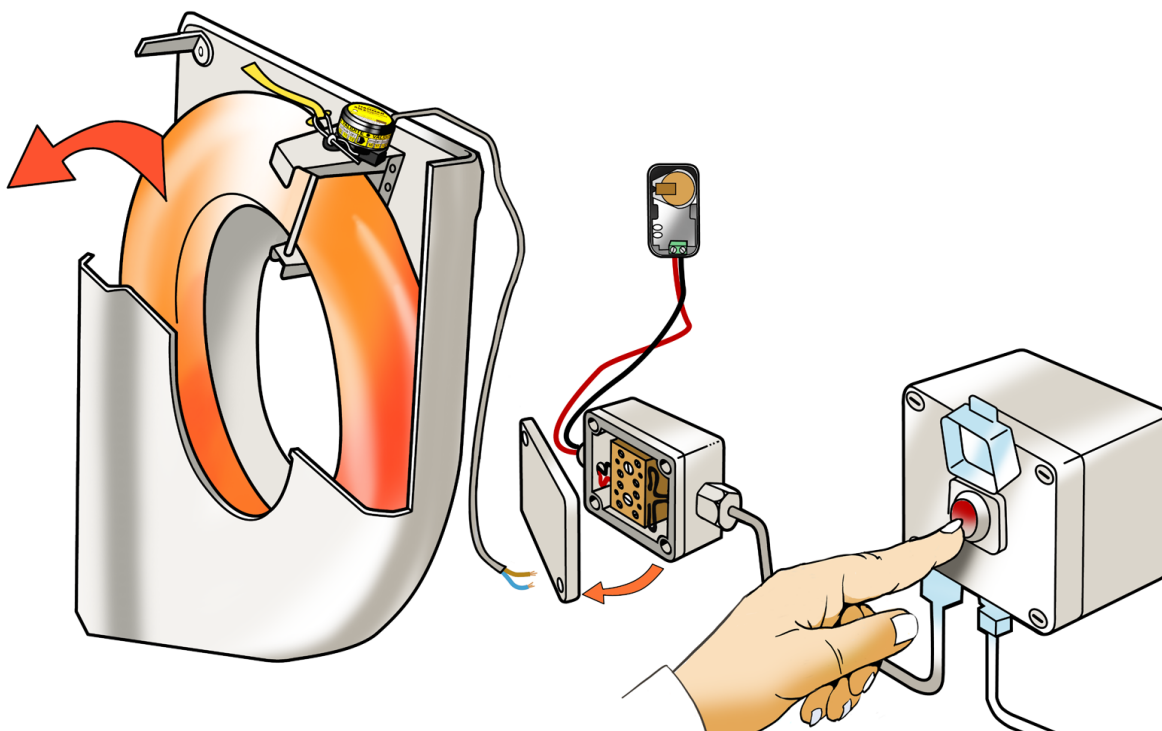

DO NOT FORGET TO RECONNECT THE H20 ERU AND THE SAFETY PIN AFTER THE TEST!