



USER MANUAL

IA-0800 MANUAL CONVERSION CAP

INSTALLATION

FROM AUTOMATIC TO MANUAL

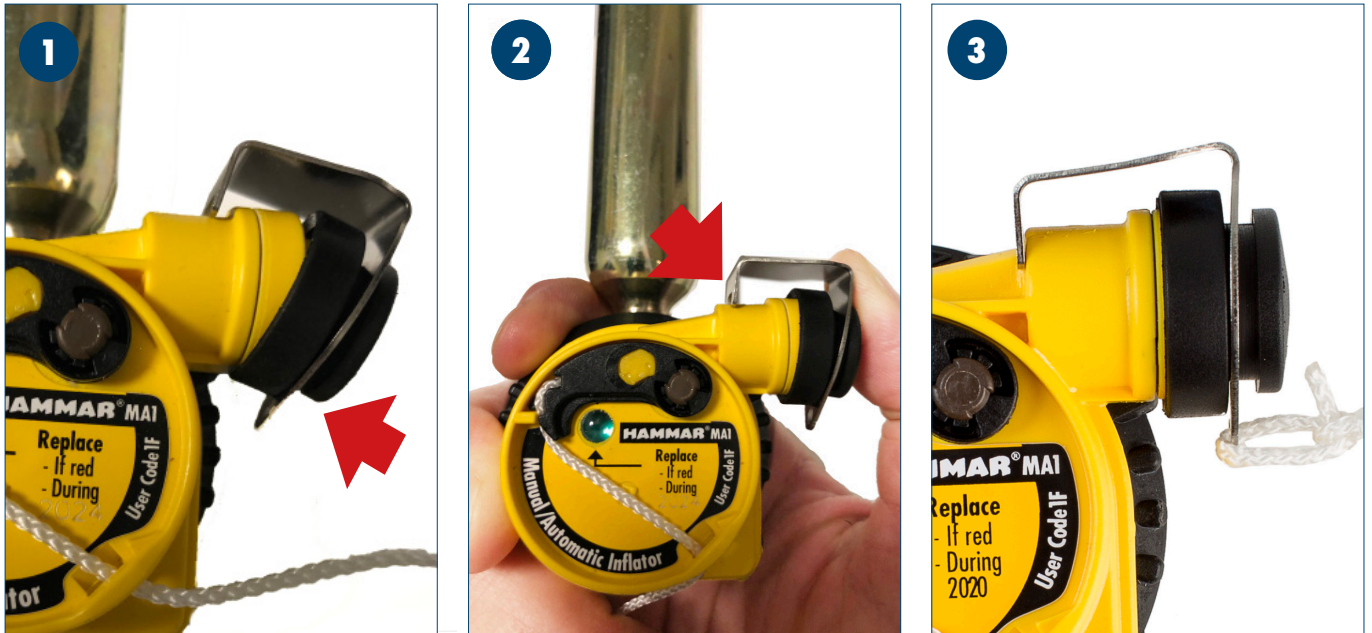

- 1** Place the rubber part of the conversion cap on the hydrostatic valve.
- 2** Push firmly on the conversion cap until the metal clip reach the plastic edge of the hydrostatic valve.
- 3** Installation is now complete.

FROM MANUAL TO AUTOMATIC



- 1** Dismount the conversion cap by puling the cord or push firmly on the metal part away from the valve.